

Terminal Block

1

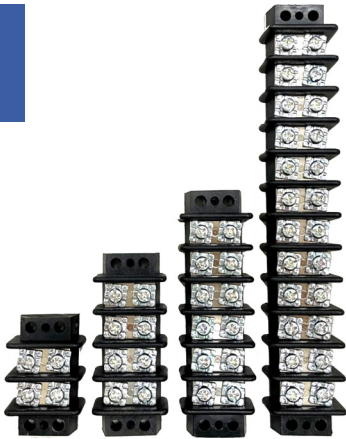

30Amp 300V Pitch 14 Terminal Block

C001-101-0001

*Rating : 30A 300VAC , Terminal : Brass, Nickel Plated 0.8t

*Body Material : Plastic NYLON 66 (UL 94V-0)

*Screw : Steel, M4, Nickel Plated Brass

*Working Temperature -40°C to +105°C

*Wire Range Awg 12~18 STR , Max. Torque Value 18Kg/cm

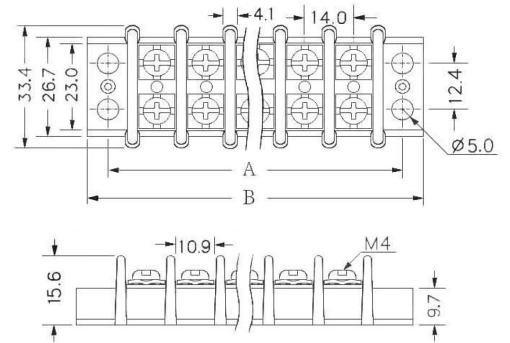
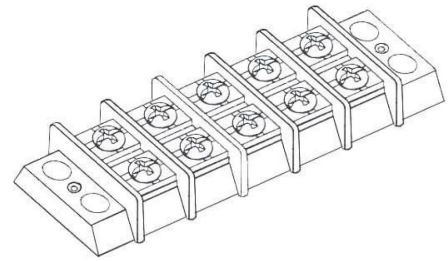

*A is the length of the idle poles from end to end of terminal block in millimeter. *B is the length of the terminal block body.

This product part number is based on the poles;

C001-101-0001-02	2P (2 poles)	C001-101-0001-20	20P (20 poles)
C001-101-0001-03	3P (3 poles)	C001-101-0001-24	24P (24 poles)
C001-101-0001-14	14P (14 poles)		

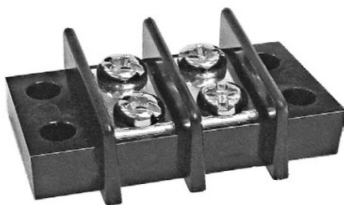

20Amp 300V Pitch 11 Barrier Terminal Blocks

C001-101-0002

*Terminal: brass, Tin plated, 0.8t

*Insulator body: PC(UL94V-0), Black

*Screw: #6-32, (steel, Ni plated), (brass), (Stainless)

*Rated current: 20Amp 300V

*Wire range: 12~22AWG

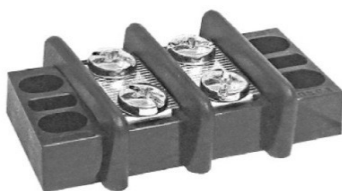
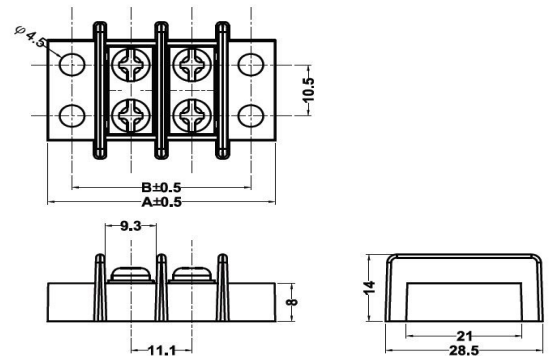

30Amp 300V Pitch 14 Barrier Terminal Blocks

C001-101-0003

*Terminal: brass, Tin plated, 0.8t

*Insulator body: PBT(UL94V-0), Black

*Screw: #8-32, (steel, Ni plated), (brass), (Stainless)

*Rated current: 30Amp 300V

*Wire range: 10~22AWG

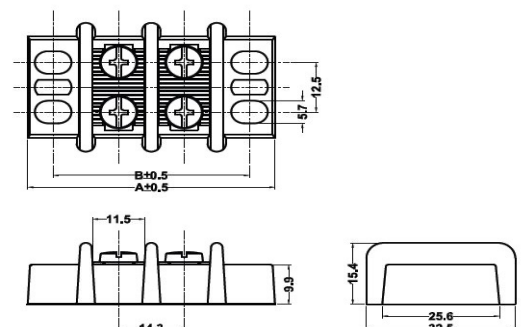

Terminal Block

2



30Amp 600V Pitch 14 Barrier Terminal Blocks

C001-101-0004

*Terminal: brass, Tin plated, 0.8t

*Insulator body: PBT(UL94V-0), Black

*Screw: #8-32, (steel, Ni plated), (brass), (Stainless)

*Rated current: 30Amp 600V

*Wire range: 10~22AWG

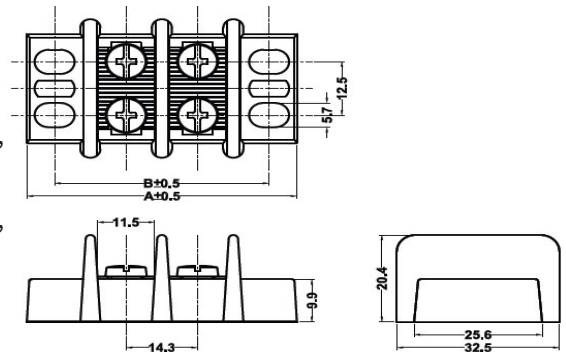

Rating 15A 300VAC Pitch 9.5mm Terminal Block

C001-101-0005

*Working Temperature : - 40 ° C ~ +105° C

*Insulation withstand Voltage : AC 1500V at 1 minute

*Insul. Resistance : 1000MΩ or More at DC 500V

*Wire Range : 22 ~12 AWG

*Max. Torque Value : 12kg-cm

Materials

Plastic Housing	PA66 , Black
Terminal	Brass , 0.8t , Tin Plated
Screw	Steel , M3.5 , Nickel Plated

Rating 30A 300VAC Pitch 11mm Terminal Block

C001-101-0006

*Working Temperature : - 40 ° C ~ +105° C

*Insulation withstand Voltage : AC 1500V at 1 minute

*Insul. Resistance : 1000MΩ or More at DC 500V

*Wire Range : 22 ~12 AWG

*Max. Torque Value : 18kg-cm

Materials

Plastic Housing	PA66 , Black
Terminal	Brass , 10t , Tin Plated
Screw	Steel , M4 , Nickel Plated

Terminal Block

3



Rating 20A 300VAC Pitch 10mm Terminal Block

C001-101-0007

*Working Temperature : - 40 ° C ~ +105° C

*Insulation withstand Voltage : AC 1500V at 1 minute

*Insul. Resistance : 1000MΩ or More at DC 500V

*Wire Rang : 22 ~12 AWG

*Max. Torque Value : 12kg-cm

Materials

Plastic Housing	PA66 , UL94V-0(option),Black
Terminal	Brass , 0.8t , Tin Plated
Screw	Steel , M3.5 , Nickel Plated



Rating 10A 300VAC Pitch 7.62mm Terminal Block

C001-101-0008

*Working Temperature : - 40 ° C ~ +105° C

*Insulation withstand Voltage : AC 1500V at 1 minute

*Insul. Resistance : 1000MΩ or More at DC 500V

*Wire Rang : 22 ~12 AWG

*Max. Torque Value : 10kg-cm

Materials

Plastic Housing	PA66 , UL94V-0(option),Black
Terminal	Brass , 0.8t , Tin Plated
Screw	Steel , M3 , Nickel Plated



Rating 15A 300VAC Pitch 8.25mm Terminal Block

C001-101-0009

*Working Temperature : - 40 ° C ~ +105° C

*Insulation withstand Voltage : AC 1500V at 1 minute

*Insul. Resistance : 1000MΩ or More at DC 500V

*Wire Rang : 22 ~12 AWG

*Max. Torque Value : 10kg-cm

Materials

Plastic Housing	PA66 , UL94V-0(option),Black
Terminal	Brass , 0.8t , Tin Plated
Screw	Steel , M3 , Nickel Plated

Terminal Block

4



Rating 15A 300VAC Pitch 9.5mm Terminal Block

C001-101-0010

*Working Temperature : - 40 ° C ~ +105° C

*Insulation withstand Voltage : AC 1500V at 1 minute

*Insul. Resistance : 1000MΩ or More at DC 500V

*Wire Rang : 22 ~12 AWG

*Max. Torque Value : 12kg-cm

Materials

Plastic Housing	PA66 , Black
Terminal	Brass , 0.8t , Tin Plated
Screw	Steel , M3.5 , Nickel Plated



Rating 15A 300VAC Pitch 8.25mm Terminal Block

C001-101-0011

*Working Temperature : - 40 ° C ~ +105° C

*Insulation withstand Voltage : AC 1500V at 1 minute

*Insul. Resistance : 1000MΩ or More at DC 500V

*Wire Rang : 22 ~12 AWG

*Max. Torque Value : 10kg-cm

Materials

Plastic Housing	PA66 , Black
Terminal	Brass , 0.8t , Tin Plated
Screw	Steel , M3 , Nickel Plated



Rating 10A 300VAC Pitch 6.35mm Terminal Block

C001-101-0012

*Working Temperature : - 40 ° C ~ +105° C

*Insulation withstand Voltage : AC 1500V at 1 minute

*Insul. Resistance : 1000MΩ or More at DC 500V

*Wire Rang : 22 ~12 AWG

*Max. Torque Value : 10kg-cm

Materials

Plastic Housing	PA66 , UL94V-0(option) , Black
Terminal	Brass , 0.8t , Tin Plated
Screw	Steel , M3 , Nickel Plated

Terminal Block

5



Rating 10A 300VAC Pitch 5.0mm Terminal Block

C001-101-0013

*Using Temperature Range : - 40° C ~ +105° C

*Insul. withstand Voltage : AC 2000V/min

*Insul. Resistance : 500MΩ or More at DC 500V

*Wire Range : 22 ~ 16 AWG

*Max. Torque Value : 4kg-cm

Materials

Housing	Polyamide 66 , Green or Blue
Solder Pin & Wire Cage	Brass , 0.6t , Tin Plated
Wire Protector	0.2 Stainless steel
Screw	M2.6 , Steel , Zine Plated



Rating 10A 300VAC Pitch 5.0mm Terminal Block

C001-101-0014

*Using Temperature Range : - 40° C ~ +105° C

*Insul. withstand Voltage : AC 2000V/min

*Insul. Resistance : 500MΩ or More at DC 500V

*Wire Range : 22 ~ 16 AWG

*Max. Torque Value : 5kg-cm

Materials

Housing	Polyamide 66 , Green
Solder Pin & Wire Cage	Brass , 0.6t , Tin Plated
Screw	M2.6 , Steel , Zine Plated



Rating 10A 300VAC Pitch 5.0mm Terminal Block

C001-101-0015

*Using Temperature Range : - 40° C ~ +105° C

*Insul. withstand Voltage : AC 2000V/min

*Insul. Resistance : 500MΩ or More at DC 500V

*Wire Rang : 14 ~ 26 AWG

*Screw Torque.Value : 5kg-cm

Materials

Housing	Polyamide 66 , Green
Clamping	Phoshor bronze, 0.4t, Nickel Plated
Wire Cage	Brass , 0.7t , Nickel Plated
Screw	M2.6 , Steel , Nickel Plated

Terminal Block

6



Rating 10A 300VAC Pitch 3.81mm Terminal Block

C001-101-0016

*Using Temperature Range : - 40° C ~ +105° C

*Insul. withstand Voltage : AC 2000V/min

*Insul. Resistance : 500MΩ or More at DC 500V

*Wire Range : 16 ~ 26 AWG

*Screw Torque.Value : 3kg-cm

Materials

Housing	Polyamide 66 , Green
Clamping	Phoshor bronze, 0.4t, Nickel Plated
Wire Cage	Brass , 0.7t , Nickel Plated
Screw	M2.0 , Steel , Nickel Plated



Rating 15A 300VAC Pitch 7.62mm Terminal Block

C001-101-0017

*Working Temperature : - 40 ° C ~ +105° C

*Insulation withstand Voltage : AC 1500V at 1 minute

*Insul. Resistance : 1000MΩ or More at DC 500V

*Wire Rang : 22 ~12 AWG

*Max. Torque Value : 8kg-cm

Materials

Plastic Housing	PBT , UL94V-0(option) , Black
Terminal	Brass , 0.8t , Tin Plated
Screw	Steel , M3 , Nickel Plated



OBDII connector

C001-103-0201

*UL2517 20AWG 4C , CABLE OD=5.5~6 , COLOR:BLACK

*OBD 16PIN MALE PLUG

*INNER PE MOLDING

*BLACK PVC 50P MOLDING

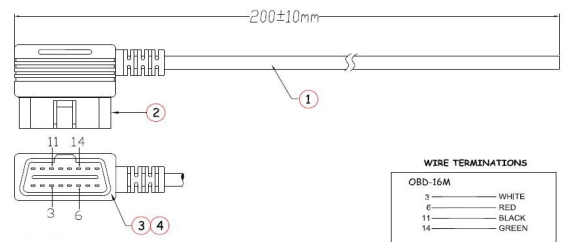

Terminal Block

7

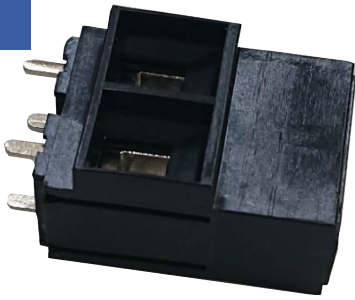

10.16mm Terminal Block

C001-101-0019

- *Voltage Rating: 300V.
- *Current Rating: 64A.
- *Solid Wire(AWG): 6-22.
- *Stranded Wire(AWG): 6-22.
- *Wire Strip Length: 11-12mm.

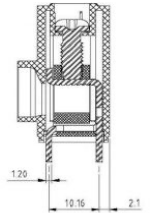
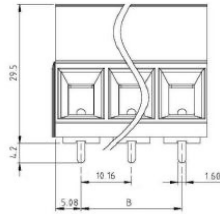
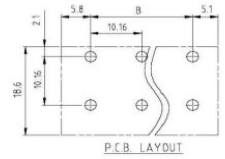
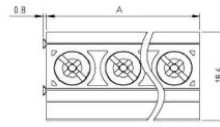

PCB M6 Terminal

C001-101-0021

- *Center Space : 8.75*13.5mm
- *Rated Current : 100A
- *Screw : M6 , Steel,Nickel plated
- *Terminal Body : Copper,Tin Plated
- *Screw Torque : 18lbin

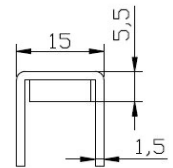
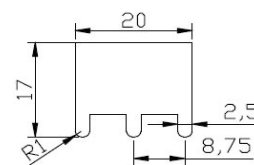
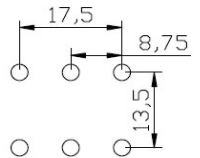
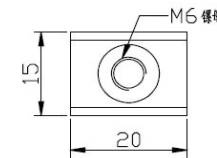

Rating 15A 300VAC Pitch 9.5mm Terminal Block

C001-101-0024

- *Plastic Housing : PA66,Black , Terminal : Brass, 0.8t, Tin Plated
- *Screw : Steel, M3.5, Nickel Plated
- *Working Temperature : - 40 ° C ~ +105 ° C , Insulation withstand Voltage : AC 1500V at 1 minute
- *Insul. Resistance : 1000MΩ or More at DC 500V
- *Wire Range : 22 ~12 AWG , Max. Torque Value : 12kg-cm

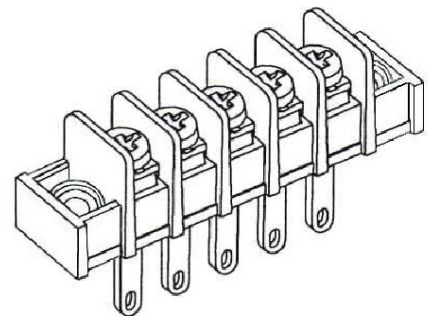

Terminal

1



HEAT SHRINK RING TERMINAL

C001-100-0302

*Material : Metal-Brass with Tin plated ,
Insulation-heat shrinkable

*RED , WIRE RANGE: 22-18/0.5-1.0 mm²

*BLUE , WIRE RANGE: 16-14/1.5-2.5 mm²

*YELLOW , WIRE RANGE: 12-10/4.0-6.0 mm²

*Wire Strip Length: 11-12mm.

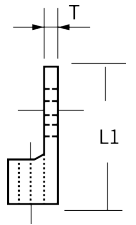
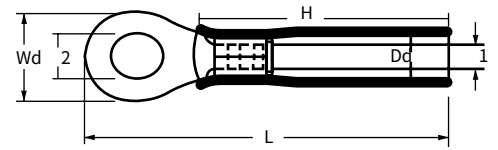

ITEM NO.	STUD SIZE		WIRE RANGE		AMP	COLOR	D	d1	d2	W	H (+-0.2)	L	L1	T
	mm	inch	AWG	mm ²										
30241	M4	#8	22-18	0.5-1.0	Max.5A	RED	5.70	1.80	4.30	6.60	18	26.0	14.0	0.8
30251	M5	#10	22-18	0.5-1.0	Max.5A	RED	5.70	1.80	5.30	8.00	20	29.8	15.8	0.8
30261	M6	#1/4	22-18	0.5-1.0	Max.5A	RED	5.70	1.80	6.70	11.60	20	35.8	21.8	0.8
302425	M4	#8	16-14	1.5-2.5	Max.20A	BLUE	6.40	2.40	4.30	7.00	18	26.0	14.0	0.8
302525	M5	#10	16-14	1.5-2.5	Max.20A	BLUE	6.40	2.40	5.30	8.50	20	30.5	16.5	0.8
302625	M6	#1/4	16-14	1.5-2.5	Max.20A	BLUE	6.40	2.40	6.30	11.00	20	35.5	21.5	0.8
30256	M5	#10	12-10	4.0-6.0	Max.40A	YELLOW	7.70	3.70	5.30	9.50	25	39.0	20.0	0.9
30266	M6	#1/4	12-10	4.0-6.0	Max.40A	YELLOW	7.70	3.70	6.70	12.00	25	40.5	21.5	0.9
30286	M8	#5/16	12-10	4.0-6.0	Max.40A	YELLOW	7.70	3.70	8.40	14.00	25	45.0	26.0	0.9
302106	M10	#3/8	12-10	4.0-6.0	Max.40A	YELLOW	7.70	3.70	10.50	15.00	25	45.5	26.5	0.9

HEAT SHRINK SPADE TERMINAL

C001-100-0304

*Material : Metal-Brass with Tin plated ,
Insulation-heat shrinkable

*RED , WIRE RANGE: 22-18/0.5-1.0 mm²

*BLUE , WIRE RANGE: 16-14/1.5-2.5 mm²

*YELLOW , WIRE RANGE: 12-10/4.0-6.0 mm²

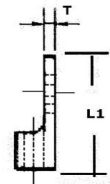
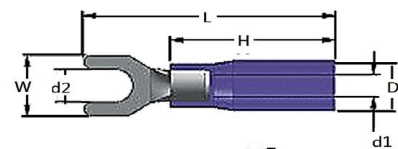

ITEM NO.	STUD SIZE		WIRE RANGE		AMP	COLOR	D (+-0.3)	d1	d2	W	H (+-0.2)	L	L1	T
	mm	inch	AWG	mm ²										
30451	M5	#10	22-18	0.5-1.0	Max.5A	RED	5.70	1.80	5.30	8.00	20	30.3	16.0	0.8
304425	M4	#8	16-14	1.5-2.5	Max.20A	BLUE	6.40	2.40	4.30	7.20	18	27.0	16.0	0.8
304525	M5	#10	16-14	1.5-2.5	Max.20A	BLUE	6.40	2.40	5.30	8.00	20	30.3	16.0	0.8
30456	M5	#10	12-10	4.0-6.0	Max.40A	YELLOW	7.70	3.70	5.30	9.00	25	39.2	19.5	0.9

Terminal

2



SERIES HEAT SHRINK FEMALE DISCONNECT

C001-100-0305

*Material : Metal-Brass with Tin plated , Insulation-heat shrinkable

*RED , WIRE RANGE: 22-18/0.5-1.0 mm²

*BLUE , WIRE RANGE: 16-14/1.5-2.5 mm²

*YELLOW , WIRE RANGE: 12-10/4.0-6.0 mm²

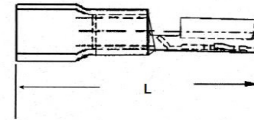
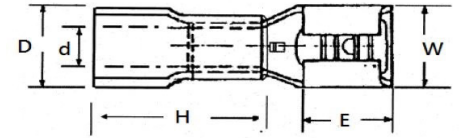

ITEM NO.	WIRE RANGE		AMP	COLOR	D (+/- 0.3)	d	W	H (+/- 0.2)	E	L	T1
	AWG	mm ²									
30501	22-18	0.5-1.0	Max.5A	RED	5.70	1.75	6.70	18	7.80	29.0	0.8
30502	16-14	1.5-2.5	Max.20A	BLUE	6.40	2.55	6.70	18	7.80	29.0	0.8
30503	12-10	4.0-6.0	Max.40A	YELLOW	7.70	3.65	6.70	22	7.80	32.9	0.8



SERIES HEAT SHRINK MALE DISCONNECT

C001-100-0306

*Material : Metal-Brass with Tin plated , Insulation-heat shrinkable

*RED , WIRE RANGE: 22-18/0.5-1.0 mm²

*BLUE , WIRE RANGE: 16-14/1.5-2.5 mm²

*YELLOW , WIRE RANGE: 12-10/4.0-6.0 mm²

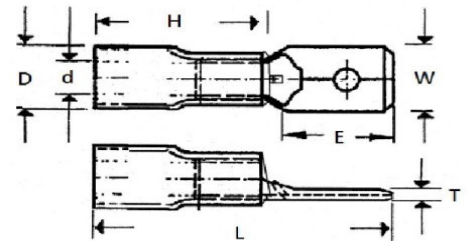

ITEM NO.	WIRE RANGE		AMP	COLOR	D (+/- 0.3)	d	W	H (+/- 0.2)	E	L	T
	AWG	mm ²									
30601-1	22-18	0.5-1.0	Max.5A	RED	5.70	1.75	6.20	18	8.13	28.8	0.8
30602-1	16-14	1.5-2.5	Max.20A	BLUE	6.40	2.55	6.20	18	8.13	28.8	0.8
30603-1	12-10	4.0-6.0	Max.40A	YELLOW	7.70	3.65	6.20	22	8.13	33.0	0.8

Terminal

3



HEAT SHRINK STEP BUTT CONNECTORS

C001-100-0307

*Material : Metal-Brass with Tin plated ,
Insulation-heat shrinkable

*RED , WIRE RANGE: 22-18/0.5-1.0 mm²

*BLUE , WIRE RANGE: 16-14/1.5-2.5 mm²

*YELLOW , WIRE RANGE: 12-10/4.0-6.0 mm²

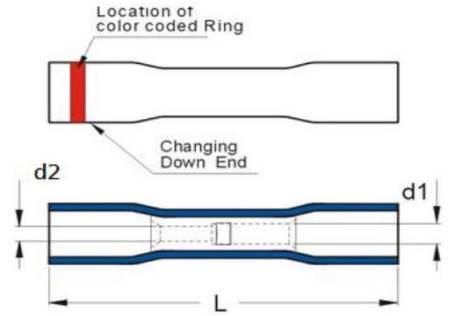

ITEM NO.	WIRE RANGE		COLOR	d1 ϕ	d2 ϕ	L
	AWG	mm ²		+0.05	+0.05	+2.0
3070001T	22-18 / 26-24	0.5-1.0 / 0.1-0.5	RED/WHITE	1.6	0.85	35.2
3070102T	16-14 / 22-18	1.5-2.5 / 0.5-1.0	BLUE/RED	2.4	1.6	36.5
3070203T	12-10 / 16-14	4.0-6.0 / 1.5-2.5	YELLOW/BLUE	3.6	2.4	49.0

HEAT SHRINK BUTT CONNECTORS

C001-100-0307

*Material : Metal-Brass with Tin plated ,
Insulation-heat shrinkable

*RED , WIRE RANGE: 22-18/0.5-1.0 mm²

*BLUE , WIRE RANGE: 16-14/1.5-2.5 mm²

*YELLOW , WIRE RANGE: 12-10/4.0-6.0 mm²

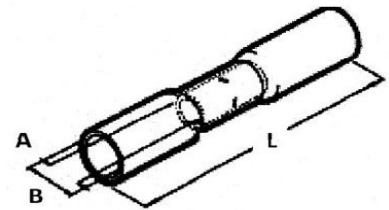
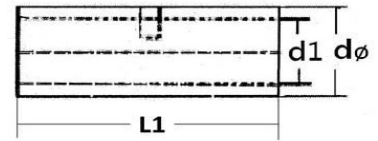

ITEM NO.	WIRE RANGE		AMP	COLOR	A	B	L	d ϕ	d1	L1
	AWG	mm ²			(+ 0.3)	(+ 0.3)				
30701T	22-18	0.5-1.0	Max.5A	RED	4.7	5.5	35	3.3	1.80	15
30702T	16-14	1.5-2.5	Max.20A	BLUE	5.7	6.4	35	4.0	2.55	15
30703T	12-10	4.0-6.0	Max.40A	YELLOW	6.7	7.7	43	5.5	3.60	15

Terminal

4



NYLON MOLDED SEAMLESS BUTT CONNECTOR

C001-100-0507

*Material : Metal-Brass with Tin plated , Insulation-Nylon

*RED , WIRE RANGE: 22-18/0.5-1.0 mm²

*BLUE , WIRE RANGE: 16-14/1.5-2.5 mm²

*YELLOW , WIRE RANGE: 12-10/4.0-6.0 mm²

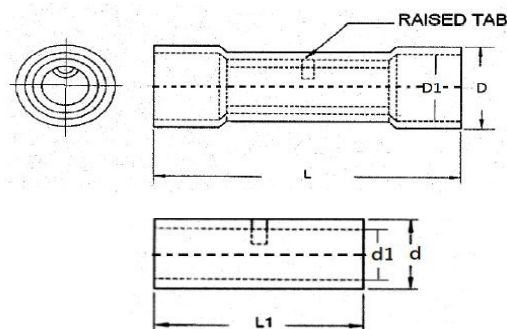

ITEM NO.	WIRE RANGE		AMP	COLOR	D	D1	d	d1	L	L1
	AWG	mm ²								
3070001T	22-18	0.5-1.0	Max.5A	RED	5.60	4.00	3.30	1.80	26	15
3070102T	16-14	1.5-2.5	Max.20A	BLUE	6.10	4.50	4.00	2.55	26	15
3070203T	12-10	4.0-6.0	Max.40A	YELLOW	8.30	6.40	5.50	3.60	27	15



FUNNEL ENTRY SPADE TERMINAL

C001-100-0904

*Material : Metal-Brass with Tin plated , Vinyl-insulated

*RED , WIRE RANGE: 22-18/0.5-1.0 mm²

*BLUE , WIRE RANGE: 16-14/1.5-2.5 mm²

*YELLOW , WIRE RANGE: 12-10/4.0-6.0 mm²

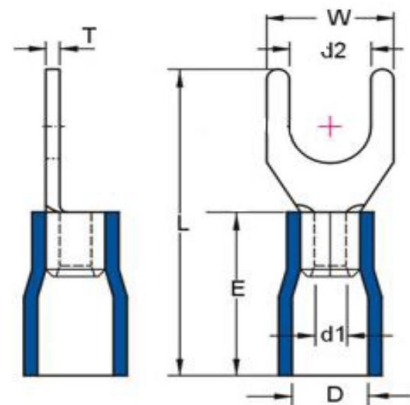

ITEM NO.	d2	Dφ	d1φ	W	E	L	T	WIRE RANGE		COLOR
	+0.2	+0.2	+0.1	+0.1	+0.2	+0.5	+0;-0.03	mm ²	AWG	
90431	3.2	3.6	1.8	6.5	10	20.2	0.8	0.5-1.0	22-18	RED
904351	3.7	3.6	1.8	6.5	10	20.2	0.8	0.5-1.0	22-18	RED
90441	4.3	3.6	1.8	7.2	10	20.2	0.8	0.5-1.0	22-18	RED
90451	5.3	3.6	1.8	8.6	10	21	0.8	0.5-1.0	22-18	RED
90461	6.4	3.6	1.8	11	10	25.3	0.8	0.5-1.0	22-18	RED
904325	3.2	4.3	2.4	6.5	10.5	19.8	0.8	1.5-2.5	16-14	BLUE
9043525	3.7	4.3	2.4	6.5	10.5	19.8	0.8	1.5-2.5	16-14	BLUE
904425	4.3	4.3	2.4	7.2	10.5	20.1	0.8	1.5-2.5	16-14	BLUE
904525	5.3	4.3	2.4	8.6	10.5	21.1	0.8	1.5-2.5	16-14	BLUE
904625	6.4	4.3	2.4	11	10.5	25.1	0.8	1.5-2.5	16-14	BLUE
904356	3.7	5.8	3.7	8.2	13.5	24.7	1.0	4.0-6.0	12-10	YELLOW
90446	4.3	5.8	3.7	8.3	13.5	24.4	1.0	4.0-6.0	12-10	YELLOW
90456	5.3	5.8	3.7	9	13.5	25.8	1.0	4.0-6.0	12-10	YELLOW
90466	6.4	5.8	3.7	12	13.5	29.3	1.0	4.0-6.0	12-10	YELLOW
90486	8.4	5.8	3.7	13.4	13.5	30.3	1.0	4.0-6.0	12-10	YELLOW

Terminal

5



FUNNEL ENTRY RING TERMINAL

C001-100-0902

*Material : Metal-Brass with Tin plated , Vinyl-insulated

*RED , WIRE RANGE: 22-18/0.5-1.0 mm²

*BLUE , WIRE RANGE: 16-14/1.5-2.5 mm²

*YELLOW , WIRE RANGE: 12-10/4.0-6.0 mm²

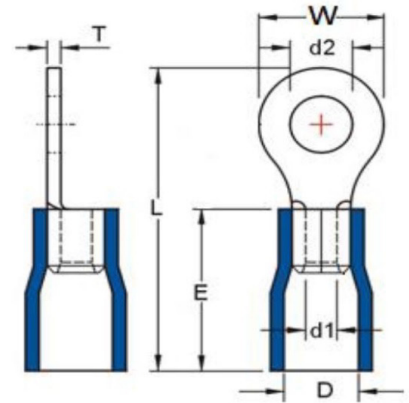

ITEM NO.	d2	D	d1	W	E	L	T	WIRE RANGE		COLOR
	±0.2	±0.2	±0.1	±0.1	±0.2	±0.5	±0;-0.03	mm ²	AWG	
90231	3.2	3.6	1.8	6.4	10	18.3	0.8	0.5-1.0	22-18	RED
902351	3.7	3.6	1.8	6.4	10	18.3	0.8	0.5-1.0	22-18	RED
90241	4.3	3.6	1.8	6.6	10	19.5	0.8	0.5-1.0	22-18	RED
90251	5.3	3.6	1.8	8.0	10	21.4	0.8	0.5-1.0	22-18	RED
90261	6.4	3.6	1.8	11.6	10	27.2	0.8	0.5-1.0	22-18	RED
90281	8.4	3.6	1.8	11.6	10	27.2	0.8	0.5-1.0	22-18	RED
90281	8.4	3.6	1.8	13.6	10	27.2	0.8	0.5-1.0	22-18	RED
902101	10.5	3.6	1.8	13.6	10	26.8	0.8	0.5-1.0	22-18	RED
902325	3.2	4.3	2.4	6.4	10.5	18.9	0.8	1.5-2.5	16-14	BLUE
9023525	3.7	4.3	2.4	6.4	10.5	18.9	0.8	1.5-2.5	16-14	BLUE
902425	4.3	4.3	2.4	7.0	10.5	20	0.8	1.5-2.5	16-14	BLUE
902525	5.3	4.3	2.4	8.5	10.5	22.2	0.8	1.5-2.5	16-14	BLUE
902625	6.4	4.3	2.4	11	10.5	28.2	0.8	1.5-2.5	16-14	BLUE
902825	8.4	4.3	2.4	12	10.5	28.2	0.8	1.5-2.5	16-14	BLUE
9021025S	10.5	4.3	2.4	13	10.5	30.8	0.8	1.5-2.5	16-14	BLUE
9021025	10.5	4.3	2.4	17	10.5	30.9	0.8	1.5-2.5	16-14	BLUE
9021225	13	4.3	2.4	19	10.5	36	0.8	1.5-2.5	16-14	BLUE
902356	3.7	5.8	3.7	7.8	13.5	24.7	1.0	4.0-6.0	12-10	YELLOW
90246	4.3	5.8	3.7	9.5	13.5	24.7	1.0	4.0-6.0	12-10	YELLOW
90256	5.3	5.8	3.7	9.5	13.5	24.7	1.0	4.0-6.0	12-10	YELLOW
90266	6.4	5.8	3.7	11	13.5	27.3	1.0	4.0-6.0	12-10	YELLOW
90286S	8.4	5.8	3.7	12	13.5	28.5	1.0	4.0-6.0	12-10	YELLOW
90286	8.4	5.8	3.7	14	13.5	34.7	1.0	4.0-6.0	12-10	YELLOW
902106	10.5	5.8	3.7	15	13.5	34.7	1.0	4.0-6.0	12-10	YELLOW
902126	13	5.8	3.7	17	13.5	39.4	1.0	4.0-6.0	12-10	YELLOW

Terminal

6



FUNNEL ENTRY FEMALE DISCONNECT

C001-100-0905

*Material : Metal-Brass with Tin plated , Vinyl-insulated

*RED , WIRE RANGE: 22-18/0.5-1.0 mm²

*BLUE , WIRE RANGE: 16-14/1.5-2.5 mm²

*YELLOW , WIRE RANGE: 12-10/4.0-6.0 mm²

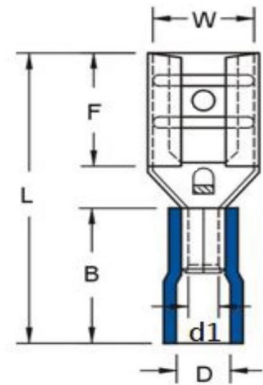

ITEM NO.	W	Dφ	d1φ	F	L	T	WIRE RANGE		COLOR
	±0.2	±0.2	±0.1	±0.2	±0.5	±0;-0.03	mm ²	AWG	
905281-5	2.8 x 0.5 110 x 02	2.9	1.8	7.8	22	0.4	0.5-1.0	22-18	RED
905281-8	2.8 x 0.8 110 x 032	2.9	1.8	7.8	22	0.4	0.5-1.0	22-18	RED
905481-5	4.8 x 0.5 110 x 02	2.9	1.8	7.8	22	0.4	0.5-1.0	22-18	RED
905481-8	4.8 x 0.8 110 x 032	2.9	1.8	7.8	22	0.4	0.5-1.0	22-18	RED
90501	6.35 x 0.8 250 x 032	2.9	1.8	7.8	22	0.4	0.5-1.0	22-18	RED
905282-5	2.8 x 0.5 110 x 02	3.7	2.4	7.8	22	0.4	1.5-2.5	16-14	BLUE
905282-8	2.8 x 0.8 110 x 032	3.7	2.4	7.8	22	0.4	1.5-2.5	16-14	BLUE
905482-5	4.8 x 0.5 110 x 02	3.7	2.4	7.8	22	0.4	1.5-2.5	16-14	BLUE
905482-8	4.8 x 0.8 110 x 032	3.7	2.4	7.8	22	0.4	1.5-2.5	16-14	BLUE
90502	6.35 x 0.8 250 x 032	3.7	2.4	7.8	22	0.4	1.5-2.5	16-14	BLUE
905082	8.2 x 0.8 315 x 032	3.7	2.4	1.0	25	0.4	1.5-2.5	16-14	BLUE
905952	9.5 x 1.2 375 x 047	3.7	2.4	13	31	0.4	1.5-2.5	16-14	BLUE
90503	6.35 x 0.8 250 x 032	5.8	3.7	7.8	24.6	0.4	4.0-6.0	12-10	YELLOW
905953	9.5 x 1.2 375 x 047	5.8	3.7	13	29.5	0.4	4.0-6.0	12-10	YELLOW



BUTT CONNECTOR

C001-100-0907

*Material : Metal-Brass with Tin plated , Vinyl-insulated

*RED , WIRE RANGE: 22-18/0.5-1.0 mm²

*BLUE , WIRE RANGE: 16-14/1.5-2.5 mm²

*YELLOW , WIRE RANGE: 12-10/4.0-6.0 mm²

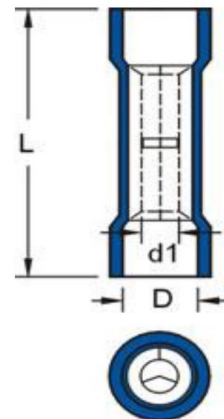

ITEM NO.	Dφ	d1φ	L	WIRE RANGE		COLOR
	±0.2	±0.1	±0.5	mm ²	AWG	
90701T	1.8	3.3	25.0	0.5-1.0	22-18	RED
90702T	2.4	4.0	25.0	1.5-2.5	16-14	BLUE
90703T	3.6	5.5	27.0	4.0-6.0	12-10	YELLOW

Terminal

7



FUNNEL ENTRY MALE DISCONNECT

C001-100-0906

*Material : Metal-Brass with Tin plated , Vinyl-insulated

*RED , WIRE RANGE: 22-18/0.5-1.0 mm²

*BLUE , WIRE RANGE: 16-14/1.5-2.5 mm²

*YELLOW , WIRE RANGE: 12-10/4.0-6.0 mm²

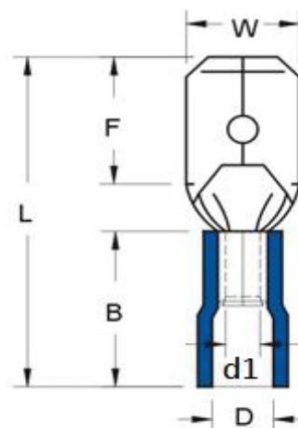

ITEM NO.	W	Dφ	d1φ	F	L	T	WIRE RANGE		COLOR
	±0.2	±0.2	±0.1	±0.2	±0.5	±0;-0.03	mm ²	AWG	
906281-5	2.8 x 0.5 110 x 02	2.9	1.8	7.8	22	0.5	0.5-1.0	22-18	RED
906281-8	2.8 x 0.8 110 x 032	2.9	1.8	7.8	22	0.8	0.5-1.0	22-18	RED
906481-5	4.8 x 0.5 110 x 02	2.9	1.8	7.8	22	0.5	0.5-1.0	22-18	RED
906481-8	4.8 x 0.8 110 x 032	2.9	1.8	7.8	22	0.4	0.5-1.0	22-18	RED
90601-1	6.35 x 0.8 250 x 032	2.9	1.8	7.8	22	0.4	0.5-1.0	22-18	RED
906282-5	2.8 x 0.5 110 x 02	3.7	2.4	7.8	22	0.5	1.5-2.5	16-14	BLUE
906282-8	2.8 x 0.8 110 x 032	3.7	2.4	7.8	22	0.8	1.5-2.5	16-14	BLUE
906482-5	4.8 x 0.5 110 x 02	3.7	2.4	7.8	22	0.5	1.5-2.5	16-14	BLUE
906482-8	4.8 x 0.8 110 x 032	3.7	2.4	7.8	22	0.4	1.5-2.5	16-14	BLUE
90602-1	6.35 x 0.8 250 x 032	3.7	2.4	7.8	22	0.4	1.5-2.5	16-14	BLUE
90603-1	6.35 x 0.8 250 x 032	5.8	3.7	7.8	24.6	0.4	4.0-6.0	12-10	YELLOW

NYLON INSULATED CLOSE END ROUND TYPE

C001-100-0916R

*Material : Metal-Brass with Tin plated , Insulation-Nylon

*RED , WIRE RANGE: 22-18/0.5-1.0 mm²

*BLUE , WIRE RANGE: 16-14/1.5-2.5 mm²

*YELLOW , WIRE RANGE: 12-10/4.0-6.0 mm²

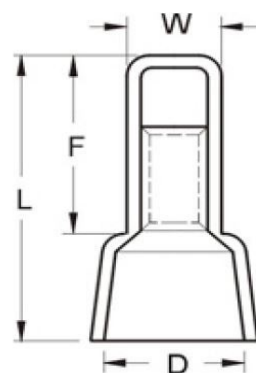

ITEM NO.	DIMENSIONS mm(inch)					WIRE RANGE	
	W	D	F	L	inside	mm ²	AWG
91601R	5.0	6.5	10.0	18.0	2.4	0.5-1.0	22-18
	.197	.256	.393	.709	.095		
91602R	5.5	8.0	12.0	21.0	3.0	1.5-2.5	16-14
	.217	.315	0.472	.827	.118		
91603R	7.0	10.5	15.0	25.0	3.8	4.0-6.0	12-10
	.276	.413	.591	.985	.150		
91604R	9.0	12.5	17.0	28.0	5.0	10	8
	.354	.492	.669	1.102	.197		

Terminal

8



3-WAY CONNECTOR

C001-100-9023

*Material : Metal-Brass with Tin plated , Vinyl-insulated

*RED , WIRE RANGE: 22-18/0.5-1.0 mm²

*BLUE , WIRE RANGE: 16-14/1.5-2.5 mm²

*YELLOW , WIRE RANGE: 12-10/4.0-6.0 mm²

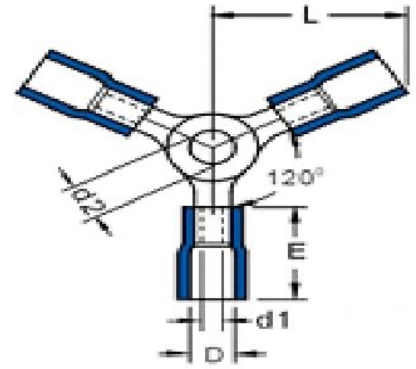

ITEM NO.	d2 φ	Dφ	dφ	E±0.2	L±0.2	WIRE RANGE	
						AWG	mm ²
3W	4.0	4.0	1.8	10.2	16.0	22-18	0.5-1.0
	0.157	0.157	0.071	0.402	0.630		
3W	4.0	4.7	2.4	10.1	15.2	16-14	1.5-2.5
	0.157	0.185	0.098	0.414	0.620		
3W	4.0	6.5	3.7	13.5	21.4	12-10	4.0-6.0
	0.157	0.255	0.146	0.530	0.843		



4-WAY CONNECTOR

C001-100-9024

*Material : Metal-Brass with Tin plated , Vinyl-insulated

*RED , WIRE RANGE: 22-18/0.5-1.0 mm²

*BLUE , WIRE RANGE: 16-14/1.5-2.5 mm²

*YELLOW , WIRE RANGE: 12-10/4.0-6.0 mm²

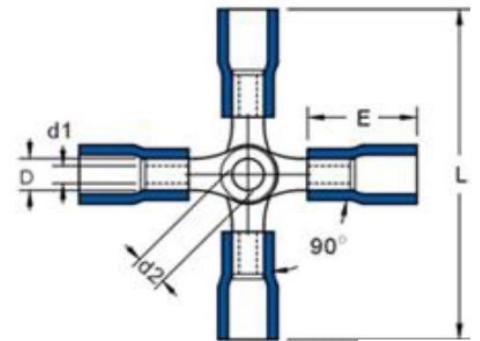

ITEM NO.	d2 φ	Dφ	dφ	E±0.2	L±0.2	WIRE RANGE	
						AWG	mm ²
4W	4.0	4.0	1.8	10.2	31.9	22-18	0.5-1.0
	0.157	0.157	0.071	0.402	1.256		
4W	4.0	4.7	2.4	10.1	30.6	16-14	1.5-2.5
	0.157	0.185	0.098	0.414	1.249		
4W	4.0	6.5	3.7	13.5	42.2	12-10	4.0-6.0
	0.157	0.255	0.146	0.530	1.661		

Terminal

9



FULLY INSULATED TERMINAL -FEMALER

C001-100-9058

*Material : Metal-Brass with Tin plated , Insulation-Nylon

*RED , WIRE RANGE: 22-18/0.5-1.0 mm²

*BLUE , WIRE RANGE: 16-14/1.5-2.5 mm²

*YELLOW , WIRE RANGE: 12-10/4.0-6.0 mm²

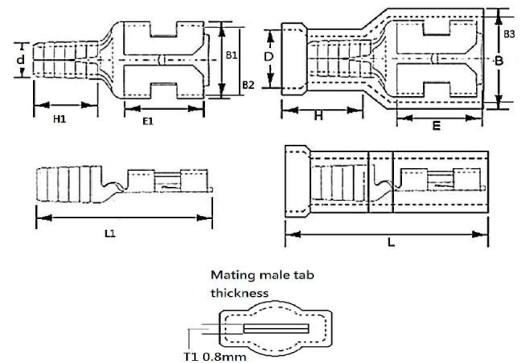

ITEM NO.	WIRE RANGE		AMP	COLOR	B (+0.2)	B1	B2	B3 (+0.2)	E	E1	D (+0.2)	d (+0.2)	L (+0.2)	L1	H	H1	T1
	AWG	mm ²															
90581	22-18	0.5-1.0	Max.5A	RED	9.64	7.80	6.78	8.47	8.75	7.50	4.43	1.75	21.77	1.65	10.63	6.00	0.80
90582	16-14	1.5-2.5	Max.20A	BLUE	9.67	7.80	6.78	8.47	8.75	7.50	4.43	2.55	21.71	1.65	10.63	6.00	0.80
90583	12-10	4.0-6.0	Max.40A	YELLOW	9.86	7.80	6.78	8.70	9.20	7.50	6.33	3.65	23.50	1.65	12.80	6.00	0.80

FULLY INSULATED TERMINAL-MALE

C001-100-9068

*Material : Metal-Brass with Tin plated , Insulation-Nylon

*RED , WIRE RANGE: 22-18/0.5-1.0 mm²

*BLUE , WIRE RANGE: 16-14/1.5-2.5 mm²

*YELLOW , WIRE RANGE: 12-10/4.0-6.0 mm²

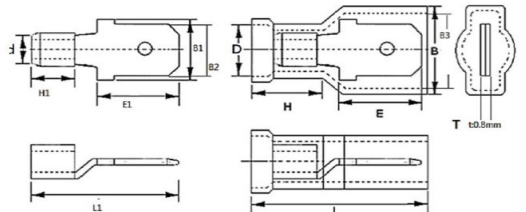

ITEM NO.	WIRE RANGE		AMP	COLOR	B (+0.2)	B1	B2	B3 (+0.2)	E/E1	D (+0.2)	d (+0.2)	L (+0.2)	L1	H	H1	T1
	AWG	mm ²														
90681	22-18	0.5-1.0	Max.5A	RED	11.47	7.40	6.20	10.05	9.50	4.43	1.75	23.27	17.00	10.57	6.00	0.80
90682	16-14	1.5-2.5	Max.20A	BLUE	11.47	7.40	6.20	10.05	9.50	4.43	2.55	23.32	17.00	10.72	6.00	0.80
90683	12-10	4.0-6.0	Max.40A	YELLOW	11.85	7.40	6.20	10.05	9.50	6.50	3.65	25.80	17.00	12.92	6.00	0.80

CRIMPING TOOL-For insulated terminals

C001-100-9901



*Pressure connector: chrome-molybdenum steel , Handle: carbon steel - for durability

*High compression pressure – for secure crimping

*Deadlock system – for safe and precise crimping

*Quick release lever – for ease of use

*For insulated terminals, red, blue & yellow, 1.5-6mm square , AWG22-10

Terminal

10

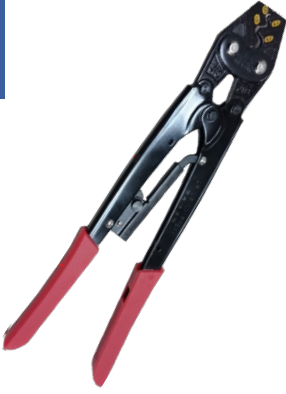

LONG ARM CRIMPING TOOL

C001-100-9902

- * Pressure connector: chrome-molybdenum steel
- * Handle: carbon steel
- * Plastic: TPE
- * Quick release lever – for ease of use
- * 1.25-8.0 mm square , AWG22-10



WIRE STRIPPER

C001-100-9903

- * Material: High Carbon Steel
- * Plastic: TPE
- * 0.5~5.5mm²(20~10AWG)
- * (Length) : 160mm, (Weigh) : 110g



CRIMPING TOOL-For Close Insulated Terminal

C001-100-9904

- * Pressure connector: chrome-molybdenum steel , Handle: carbon steel - for durability
- * High compression pressure – for secure crimping
- * Deadlock system – for safe and precise crimping
- * Quick release lever – for ease of use
- * For closed terminals, 1.5-6mm square , AWG22-10use

Terminal

11

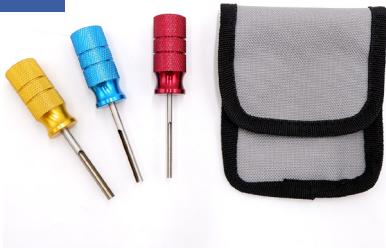

Deutsch Terminal Tool Kit (3pcs)

C001-100-9905

*Provides coverage for wire gauges between 14-20 and includes combination wedge removal tool."

*Deutsch connectors used for: automotive, motorcycles, HD trucks, construction equipment, agricultural equipment and some outboard engines.

*Release terminals safely without damaging the vehicle wiring harness and/or terminal block

*Stainless steel shaft construction and fitted, anodized aluminum handles with knurled surface for improved grip and control.

*Precisely trimmed and machined; insertion and release tools.

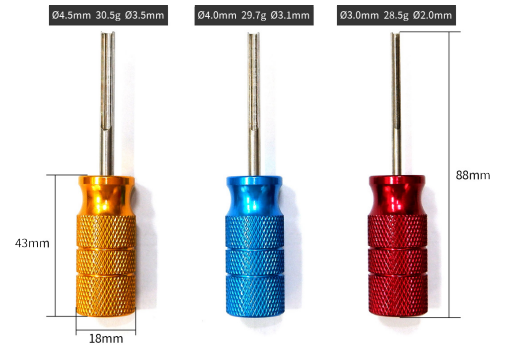

Deutsch Terminal Tool Kit (7pcs)

C001-100-9907



*Provides coverage for wire gauges between 4-20 and includes combination wedge removal tool/miniature flat tip screwdriver.

*Deutsch connectors used for: automotive, motorcycles, HD trucks, construction equipment, agricultural equipment and some outboard engines.

*Release terminals safely without damaging the vehicle wiring harness and/or terminal block.

*Stainless steel shaft construction and fitted, anodized aluminum handles with knurled surface for improved grip and control.

*Precisely trimmed and machined; insertion and release tools.

Combination wedge removal tool		
4 Gauge	8 Gauge	12 Gauge
C001-100-990604	C001-100-990608	C001-100-990612
Flat tip screwdriver tool		
14 Gauge	16 Gauge	20 Gauge
C001-100-990614	C001-100-990616	C001-100-990620

Terminal

12



Deutsch Connector Crimping Tool

C001-100-9908

*Weight:234g

*Material :

1.Body made by S50C Carbon Steel, hardness@HRC40-45

2.Indenter made by FD-0405 steel, hardness@HRC35-45

*Work with DEUTSCH solid contact Size#20 with wire AWG 20-22

*Comfortable cushioned grips

*Features ratchet mechanism to complete an effective crimp

*Customized handle grip color is available

*4-way indent crimping

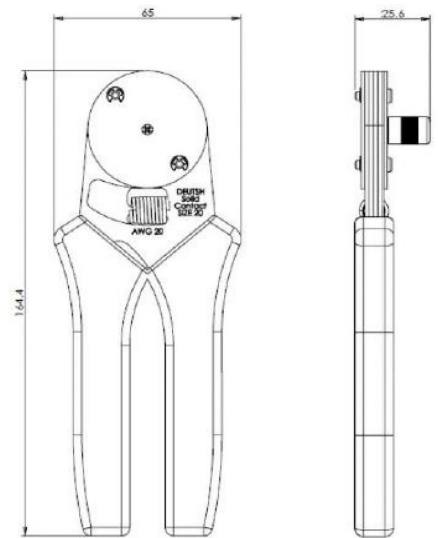

Deutsch Connector Crimping Tool

C001-100-9909

*Weight:234g

*Material:

1.Body made by S50C Carbon Steel, hardness@HRC40-45

2.Indenter made by FD-0405 steel, hardness@HRC35-45

*Work with DEUTSCH solid contact Size#16 with wire AWG16/18/20

*Comfortable cushioned grips

*Features ratchet mechanism to complete an effective crimp

*Customized handle grip color is available

*4-way indent crimping

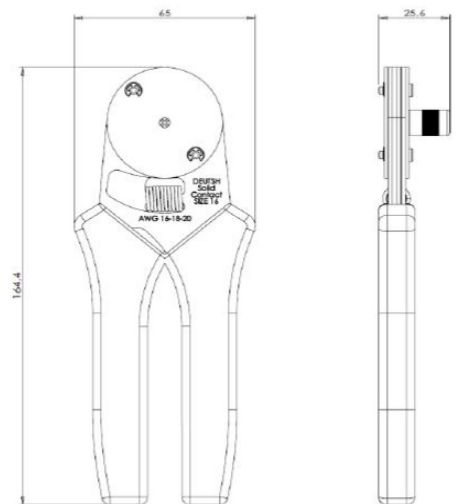

Terminal

13



Deutsch Connector Crimping Tool

C001-100-9910

*Weight:238g,Length:164.4mm,Width:65.2 mm,thickness:26.6mm

*Material :

1.Body made by S50C Carbon Steel, hardness@HRC40-45

2.Indenter made by FD-0405 steel, hardness@HRC35-45

*Work with DEUTSCH solid contact Size#12 with wire AWG12-14

*Comfortable cushioned grips

*Features ratchet mechanism to complete an effective crimp

*Customized handle grip color is available

*4-way indent crimping

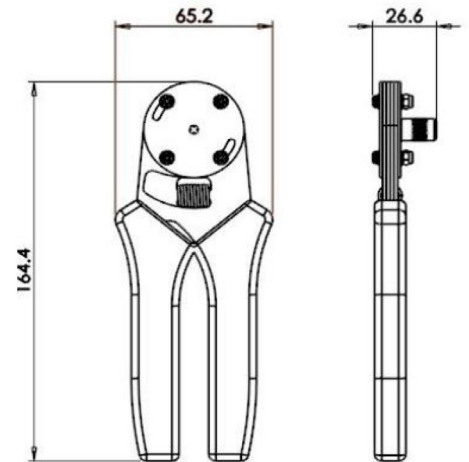

Deutsch Connector Crimping Tool

C001-100-9911

*Weight:255g

*Material :

1.Body made by S50C Carbon Steel, hardness@HRC40-45

2.Indenter made by FD-0405 steel, hardness@HRC35-45

*Work with DEUTSCH solid contact Size#20 with wire AWG20-22

*Comfortable cushioned grips

*Features ratchet mechanism to complete an effective crimp

*Customized handle grip color is available

*4-way indent crimping

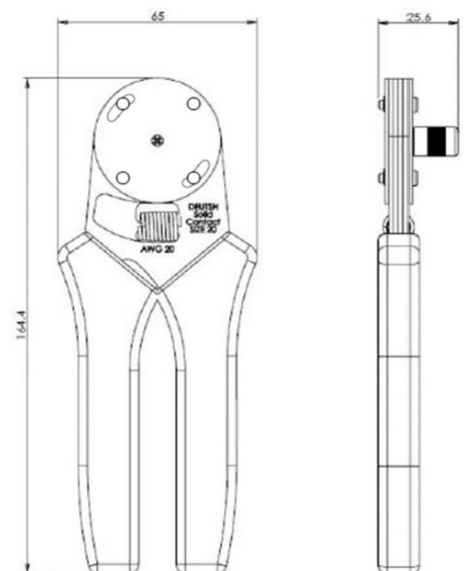

Terminal

14



Deutsch Connector Crimping Tool

C001-100-9912

*Weight:255g

*Material :

1.Body made by S50C Carbon Steel, hardness@HRC40-45

2.Indenter made by FD-0405 steel, hardness@HRC35-45

*Work with DEUTSCH solid contact Size#16 with wire AWG16/18

*Comfortable cushioned grips

*Features ratchet mechanism to complete an effective crimp

*Customized handle grip color is available

*4-way indent crimping

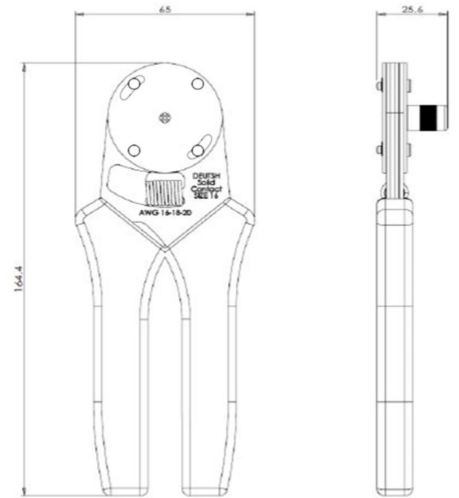

Deutsch Connector Crimping Tool

C001-100-9913

*Weight:238g,Length:164.4mm,Width:65.2 mm,thickness:26.6mm

*Material :

1.Body made by S50C Carbon Steel, hardness@HRC40-45

2.Indenter made by FD-0405 steel, hardness@HRC35-45

*Work with DEUTSCH solid contact Size#12 with wire AWG12-14

*Comfortable cushioned grips

*Features ratchet mechanism to complete an effective crimp

*Customized handle grip color is available

*4-way indent crimping

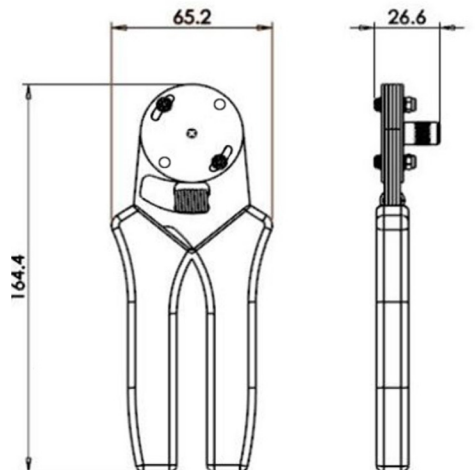

Terminal

15



Deutsch DT Series

C001-100-DT Series

*Watts/Amp Rating: 13A Each Pin



*Connection Type: Plug/Receptacle/Pin Set



*Product Properties: Rugged Thermoplastic Housing, Silicone Rubber Grommet, Accepts AWG 20-14 Wire

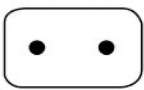

*Terminal Material: Nickel Plated Copper Alloy, Colour: Grey



*Application: Suits Size 16 Applications, Uses 0.5-1.3mm² Wire

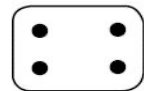

SIZE	SOLID CONTACT PART NUMBERS		WIRE SIZE AWG (mm ²)	RECOMMENDED STRIP LENGTH INCHES(mm)
	PIN	SOCKET		
16	C001-100-DT01	C001-100-DT02	16-20 (1.0-0.50)	250-312 (6.35-7.92)

 <p>2 2 size 16</p>	
 <p>C001-100-DT04-2P</p>	 <p>C001-100-DT06-2S</p>

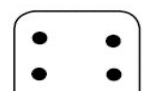
 <p>3 3 size 16</p>	
 <p>C001-100-DT04-3P</p>	 <p>C001-100-DT06-3S</p>

 <p>4 4 size 16</p>	
 <p>C001-100-DT04-4P</p>	 <p>C001-100-DT06-4S</p>

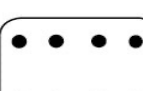
 <p>6 6 size 16</p>	
 <p>C001-100-DT04-6P</p>	 <p>C001-100-DT06-6S</p>

 <p>8 8 size 16</p>	
 <p>C001-100-DT04-8P</p>	 <p>C001-100-DT06-8S</p>

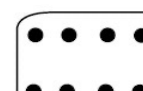
 <p>12 12 size 16</p>	
 <p>C001-100-DT04-12P</p>	 <p>C001-100-DT06-12S</p>

Terminal

16



DT 2 pin with flange

C001-100-DT04-2P-L012

*Series: Deutsch DT

*Contact Size: 16

*Wire Range: 14, 16, 18, 20 depending on contact/terminal used

*Gender: Receptacle/ holds pin contact/ terminal

*Suitable for up to 13 amps continuous

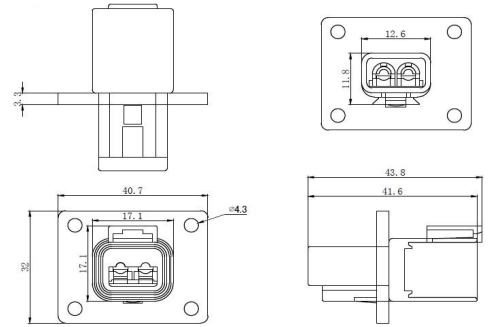

8 Gauge uninsulated butt connectors

C001-100-B8

*TERMINAL MATERIAL : Copper Tubular

*SURFACE TREATMENT : Tin-Plated

*WIRE RANGE : 8 A.W.G. 8 mm²

*MAX. Current Rating : 62A

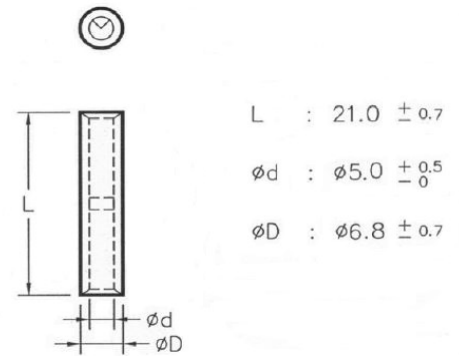

NON-INSULATED RING TERMINALS (BRAZED SEAM)

C001-100-R1

*TERMINAL MATERIAL : COPPER

*SURFACE TREATMENT : Tin-Plated

*WIRE RANGE : 22-16 A.W.G. 0.5-1.5 mm²

*THICKNESS : T: 0.75mm

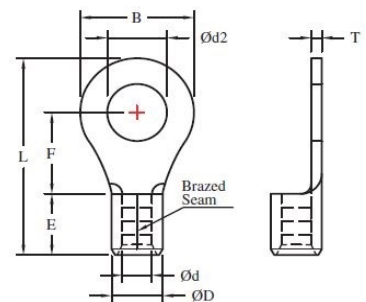

WIRE RANGE A.W.G. mm ²	ITEM NO.	Stud Size		Dimensions(mm)							
		American	Metric	ød2	B	F	L	E	ød	øD	T
22-16 A.W.G. 0.5-1.5 mm ²	R1-3NB	#4	3.0	3.2	5.5	4.8	12.5	5.0	1.7	3.4	0.75
	R1-3.5SNB	#6	3.5	3.7	5.5	4.8	12.5				
	R1-3.5NB	#6	3.5	3.7	6.6	6.3	14.6				
	R1-4SNB	#8	4.0	4.3	6.6	6.3	14.6				
	R1-4NB	#8	4.0	4.3	8.0	7.0	16.0				
	R1-5NB	#10	5.0	5.3	8.0	7.0	16.0				
	R1-6NB	1/4	6.0	6.4	11.6	11.1	21.9				
	R1-8NB	5/16	8.0	8.4	11.6	11.1	21.9				
	R1-10NB	3/8	10.0	10.5	13.6	13.9	25.7				
	R1-12NB	1/2	12.0	13.0	19.0	16.0	30.6				

Terminal

17

NON-INSULATED RING TERMINALS(BRAZED SEAM)

C001-100-R2

*TERMINAL MATERIAL : COPPER

*SURFACE TREATMENT : Tin-Plated

*WIRE RANGE : 16-14 A.W.G. 1.5-2.5 mm²

*THICKNESS : T: 0.8mm

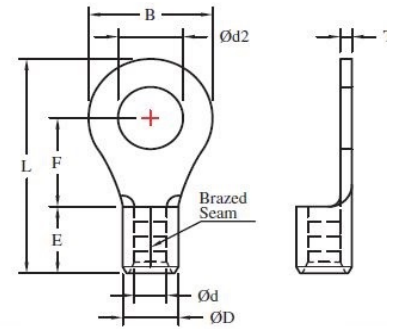

WIRE RANGE A.W.G. mm ²	ITEM NO.	Stud Size		Dimensions(mm)							
		American	Metric	Ød2	B	F	L	E	Ød	ØD	T
16-14 A.W.G. 1.5-2.5 mm ²	R2-3NB	#4	3.0	3.2	6.6	4.3	12.6	5.0	2.3	4.1	0.8
	R2-3.5SNB	#6	3.5	3.7	6.6	4.3	12.6				
	R2-3.5NB	#6	3.5	3.7	6.6	6.3	14.6				
	R2-4SNB	#8	4.0	4.3	6.6	6.3	14.6				
	R2-4NB	#8	4.0	4.3	8.5	7.8	17.0				
	R2-5SNB	#10	5.0	5.3	8.5	7.8	17.0				
	R2-5NB	#10	5.0	5.3	9.5	7.3	17.0				
	R2-6NB	1/4	6.0	6.4	12.0	11.0	22.0				
	R2-8NB	5/16	8.0	8.4	12.0	11.0	22.0				
	R2-10NB	3/8	10.0	10.5	13.6	13.9	25.7				
R2-12NB	1/2	12.0	13.0	19.0	16.0	30.6					

NON-INSULATED RING TERMINALS(BRAZED SEAM)

C001-100-R3

*TERMINAL MATERIAL : COPPER

*SURFACE TREATMENT : Tin-Plated

*WIRE RANGE : 14-12 A.W.G. 2.5-4 mm²

*THICKNESS : T: 1.0mm

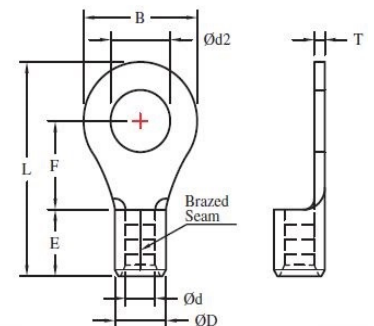

WIRE RANGE A.W.G. mm ²	ITEM NO.	Stud Size		Dimensions(mm)							
		American	Metric	Ød2	B	F	L	E	Ød	ØD	T
14-12 A.W.G. 2.5-4 mm ²	R3-4NB	#8	4.0	4.3	8.0	7.8	17.8	6.0	2.9	5.1	1.0
	R3-5NB	#10	5.0	5.3	8.0	7.8	17.8				
	R3-5LNB	#10	5.0	5.3	12.0	9.4	21.4				
	R3-6NB	1/4	6.0	6.4	12.0	9.4	21.4				
	R3-8NB	5/16	8.0	8.4	15.0	13.3	26.8				
	R3-10NB	3/8	10.0	10.5	15.0	13.3	26.8				
	R3-12NB	1/2	12.0	13.0	19.2	16.0	31.6				

Terminal

18

NON-INSULATED RING TERMINALS(BRAZED SEAM)

C001-100-R5

*TERMINAL MATERIAL : COPPER

*SURFACE TREATMENT : Tin-Plated

*WIRE RANGE : 12-10 A.W.G. 4-6 mm²

*THICKNESS : T: 1.0mm

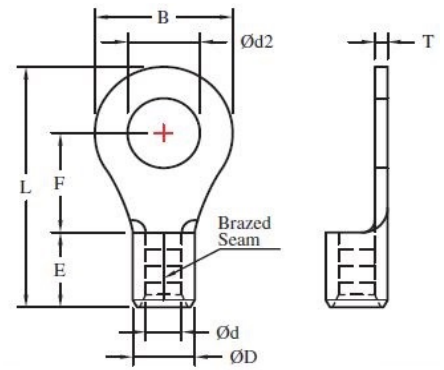

WIRE RANGE A.W.G. mm ²	ITEM NO.	Stud Size		Dimensions(mm)							
		American	Metric	Ød2	B	F	L	E	Ød	ØD	T
12-10 A.W.G. 4-6 mm ²	R5-3.5NB	#6	3.5	3.7	7.2	5.9	15.5	6.0	3.4	5.6	1.0
	R5-4SNB	#8	4.0	4.3	7.2	5.9	15.5				
	R5-4NB	#8	4.0	4.3	9.5	8.3	19.0				
	R5-5NB	#10	5.0	5.3	9.5	8.3	19.0				
	R5-6NB	1/4	6.0	6.4	12.0	10.5	22.5				
	R5-8NB	5/16	8.0	8.4	15.0	13.7	27.2				
	R5-10NB	3/8	10.0	10.5	15.0	13.7	27.2				
R5-12NB	1/2	12.0	13.0	19.2	16.0	31.6					

NON-INSULATED RING TERMINALS(BRAZED SEAM)

C001-100-R8

*TERMINAL MATERIAL : COPPER

*SURFACE TREATMENT : Tin-Plated

*WIRE RANGE : 8 A.W.G. 8 mm²

*THICKNESS : T: 1.2mm

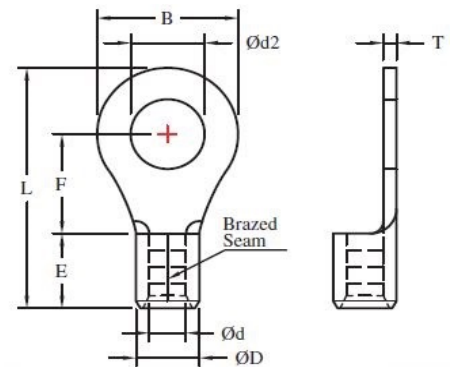

WIRE RANGE A.W.G. mm ²	ITEM NO.	Stud Size		Dimensions(mm)							
		American	Metric	Ød2	B	F	L	E	Ød	ØD	T
8 A.W.G. 8 mm ²	R8-3.5NB	#6	3.5	3.7	8.0	9.3	21.8	8.5	4.5	7.1	1.2
	R8-4SNB	#8	4.0	4.3	8.0	9.3	21.8				
	R8-4NB	#8	4.0	4.3	12.0	9.3	23.8				
	R8-5SNB	#10	5.0	5.3	9.0	9.3	22.3				
	R8-5NB	#10	5.0	5.3	12.0	9.3	23.8				
	R8-5LNB	#10	5.0	5.3	15.0	13.8	29.8				
	R8-6NB	1/4	6.0	6.4	12.0	9.3	23.8				
	R8-6LNB	1/4	6.0	6.4	15.0	13.8	29.8				
	R8-8NB	5/16	8.0	8.4	15.0	13.8	29.8				
	R8-10NB	3/8	10.0	10.5	15.0	13.8	29.8				
	R8-12NB	1/2	12.0	13.0	20.0	15.0	33.5				

Terminal

19

NON-INSULATED RING TERMINALS(BRAZED SEAM)

C001-100-R14



- *TERMINAL MATERIAL : COPPER
- *SURFACE TREATMENT : Tin-Plated
- *WIRE RANGE : 6 A.W.G. 14 mm²
- *THICKNESS : T: 1.5mm

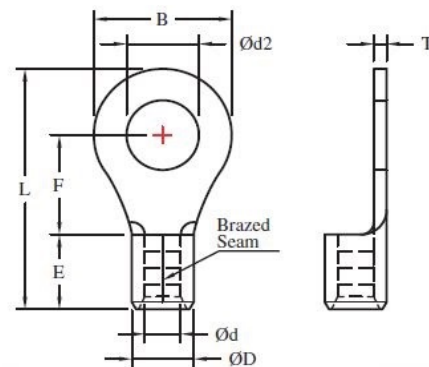

WIRE RANGE A.W.G. mm ²	ITEM NO.	Stud Size		Dimensions(mm)							
		American	Metric	Ød2	B	F	L	E	Ød	ØD	T
6 A.W.G. 14 mm ²	R14-4NB	#8	4.0	4.3	12.0	13.3	29.8	10.5	5.8	9.0	1.5
	R14-5NB	#10	5.0	5.3	12.0	13.3	29.8				
	R14-6NB	1/4	6.0	6.4	12.0	13.3	29.8				
	R14-6LNB	1/4	6.0	6.6	16.0	14.5	33.0				
	R14-8NB	5/16	8.0	8.4	16.0	14.5	33.0				
	R14-10NB	3/8	10.0	10.5	16.0	14.5	33.0				
	R14-11NB	7/16	11.0	11.5	22.0	19.5	41.0				
	R14-12NB	1/2	12.0	13.0	22.0	19.5	41.0				

NON-INSULATED RING TERMINALS(BRAZED SEAM)

C001-100-R22



- *TERMINAL MATERIAL : COPPER
- *SURFACE TREATMENT : Tin-Plated
- *WIRE RANGE : 4 A.W.G. 22 mm²
- *THICKNESS : T: 1.8mm

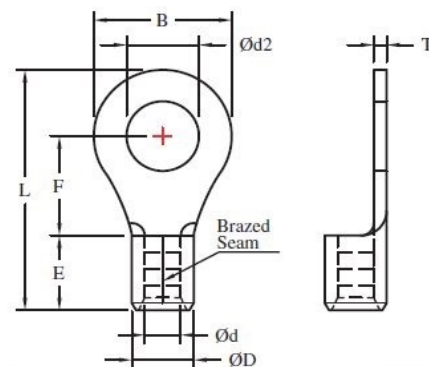

WIRE RANGE A.W.G. mm ²	ITEM NO.	Stud Size		Dimensions(mm)							
		American	Metric	Ød2	B	F	L	E	Ød	ØD	T
4 A.W.G. 22 mm ²	R22-5SNB	#10	5.0	5.3	12.0	12.0	30.0	12.0	7.7	11.5	1.8
	R22-5NB	#10	5.0	5.3	16.5	13.5	33.7				
	R22-6SNB	1/4	6.0	6.4	12.0	12.0	30.0				
	R22-6NB	1/4	6.0	6.6	16.5	13.5	33.7				
	R22-8SNB	5/16	8.0	8.4	12.0	12.0	30.0				
	R22-8NB	5/16	8.0	8.4	16.5	13.5	33.7				
	R22-10SNB	3/8	10.0	10.5	16.5	13.5	33.7				
	R22-10NB	3/8	10.0	10.5	17.5	16.0	36.7				
	R22-11NB	7/16	11.0	11.5	22.0	19.5	42.5				
	R22-12NB	1/2	12.0	13.0	22.0	19.5	42.5				